

RT-3 SP



HIGH PRECISION LATHE

REALMECA

BUILT like a ROCK

A lathe of small capacity and high precision, designed for micromechanics :

- Made for low-to-medium production volumes ;
- Its bed is made of a composite material of high density guarantying :
 - Vibration absorption,
 - High stress resistance,
 - Thermal stability;
- High speed spindle ;
- Designed for easy chip evacuation ;
- High-precision, selectively sorted needle roller guides ;
- 2µm flatness, parallelism and perpendicularity ;
- Short drive chain ;
- Phosphate treatment of metal surfaces.

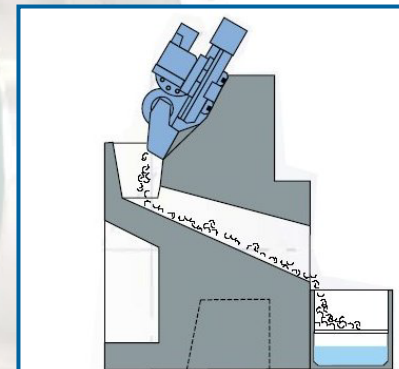
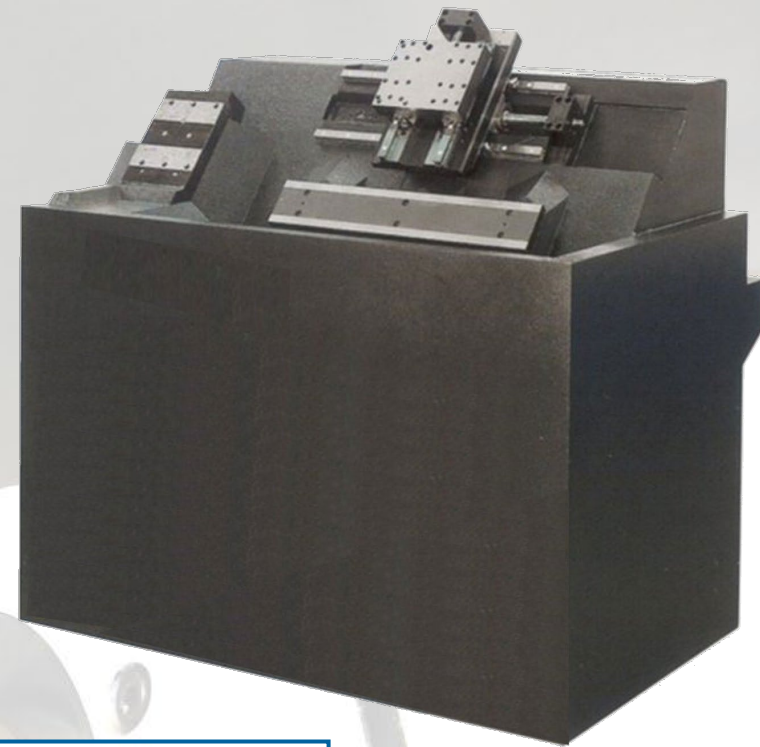

Banc incliné à 50°.
Evacuation aisée des copeaux
par l'arrière de la machine.

A 50° slope in the bed.
Easy chip evacuation at the
back of the machine.

CAPACITY	
X axis	120 mm
Z axis	320 mm
Between centers	400 mm
Tailstock	CM2
C axis	360 000 x 0,001°
SPINDLE	
Max. speed	6000 rpm
Max. rating	4 kW
Spindle nose	Ø 90 mm
Bar capacity	32 mm
FEEDRATES	
Max. cutting	30 m/min
Rapids	30 m/min
C axis	6000 rpm
Precision	0,1µ/ 0,001°
TURRET	
Capacity VDI 16	8/12/16
Capacity VDI 20	8
Size / Mass	
Length / Width / Height	1920 x 1580 x 1720 mm
Weight	2800 kg

OPTIONS	
LIVE-TOOLING	
Capacity VDI 16	12/16
Number of live-tool position	6/8
Max. rpm	6000 rpm
Rating	1,5 kW

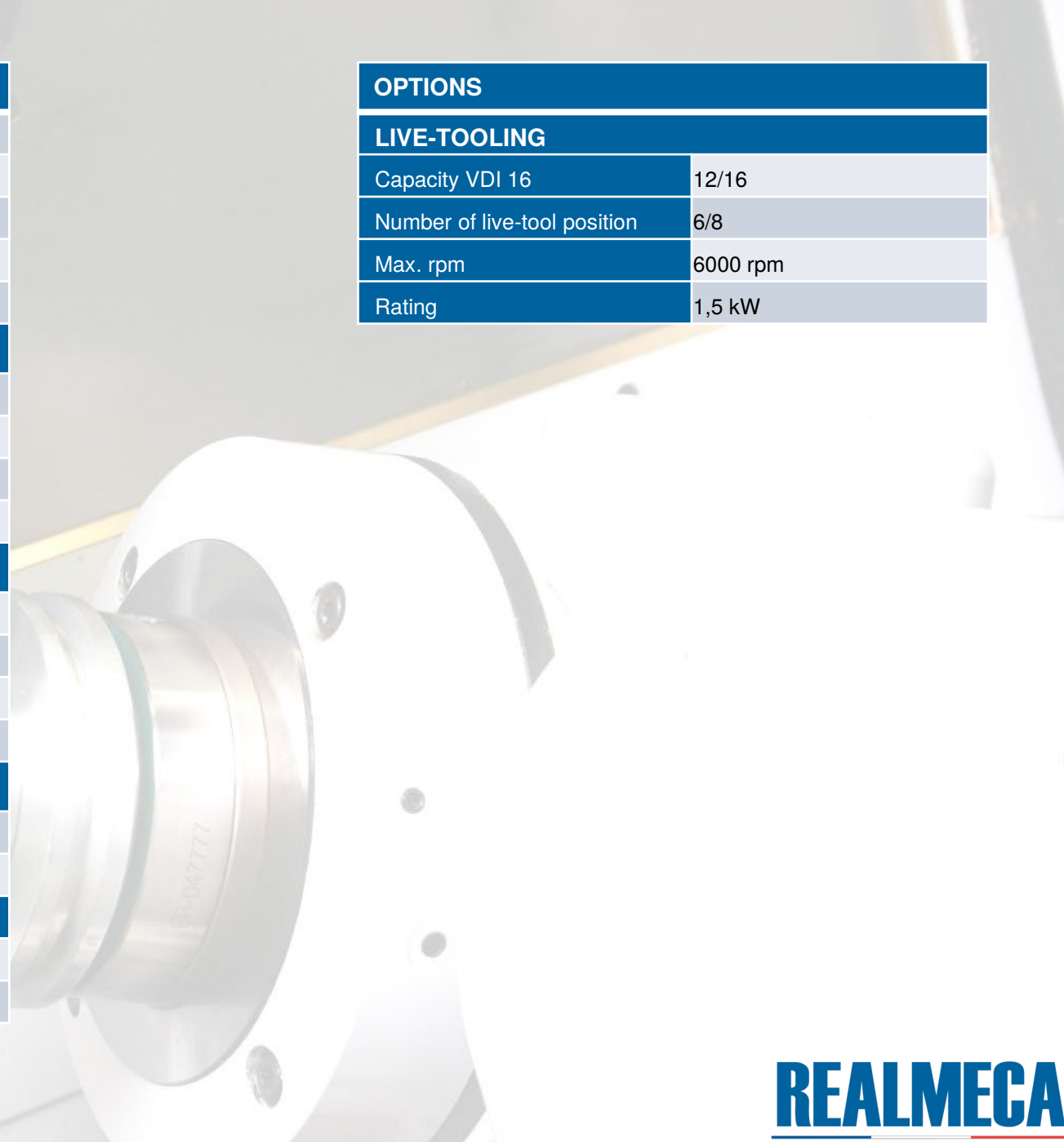



8 tools VDI16 turret

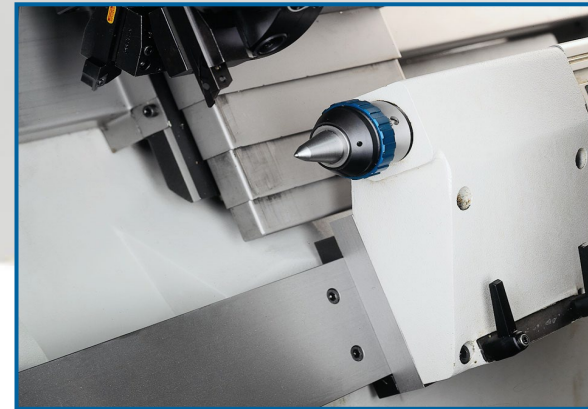

- Tailstock
- Manual positioning
- Movement of the pneumatic cylinder



8 tools VDI20 turret

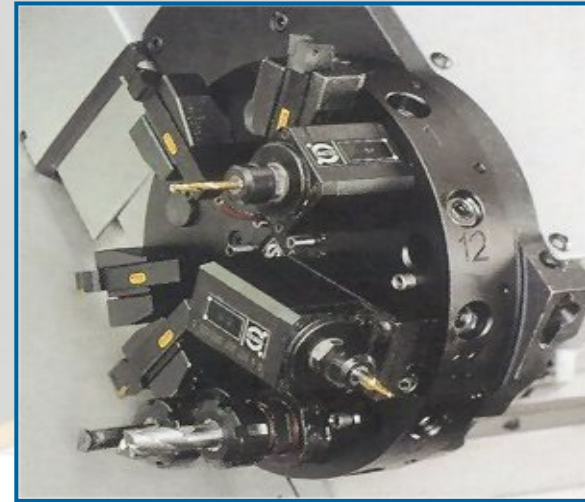

C-axis and 12 tools VDI16 turret,
including 6 live-tooling slots, 6000 rpm,
1kW



Spindle motor 5,5 / 7,5 kW

Spindle motor 4 kW

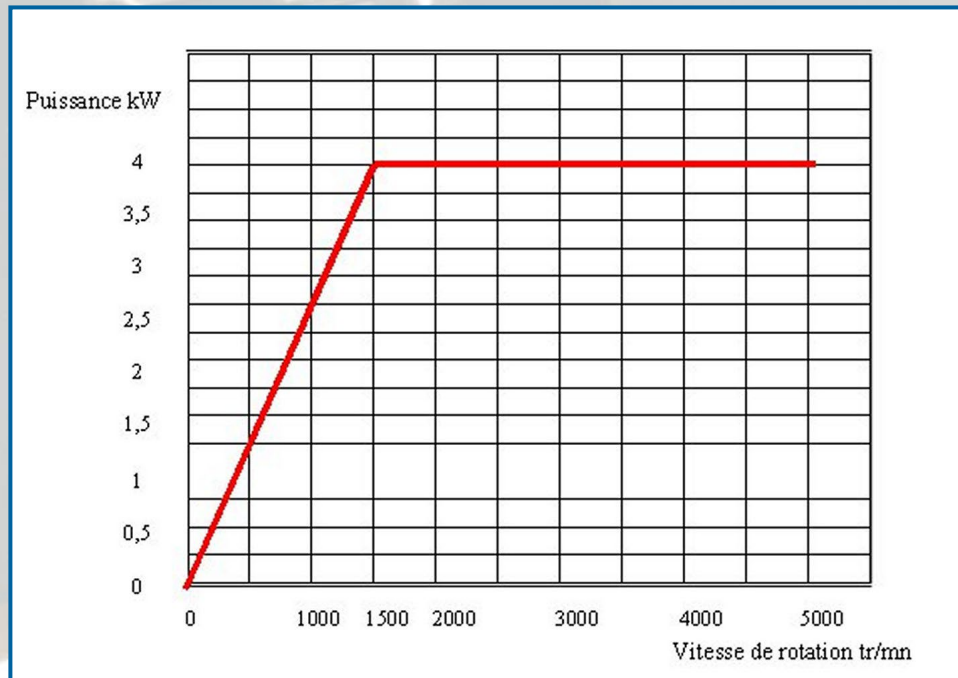

Spindle motor 5,5 / 7,5 kW (option)

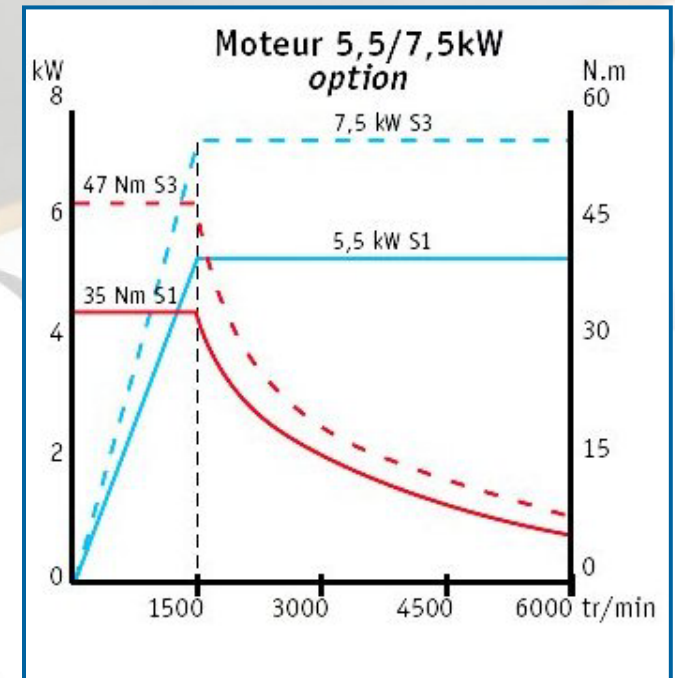

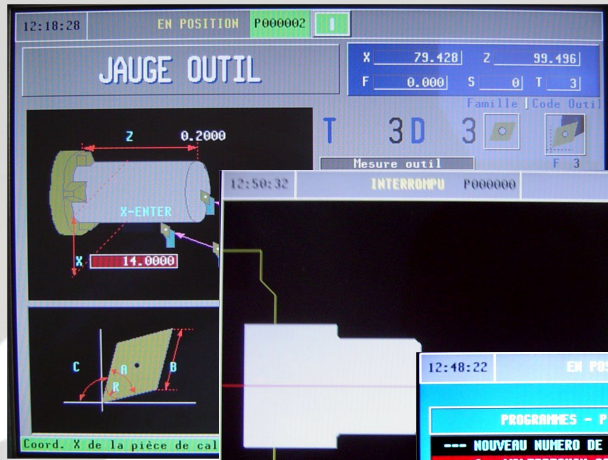

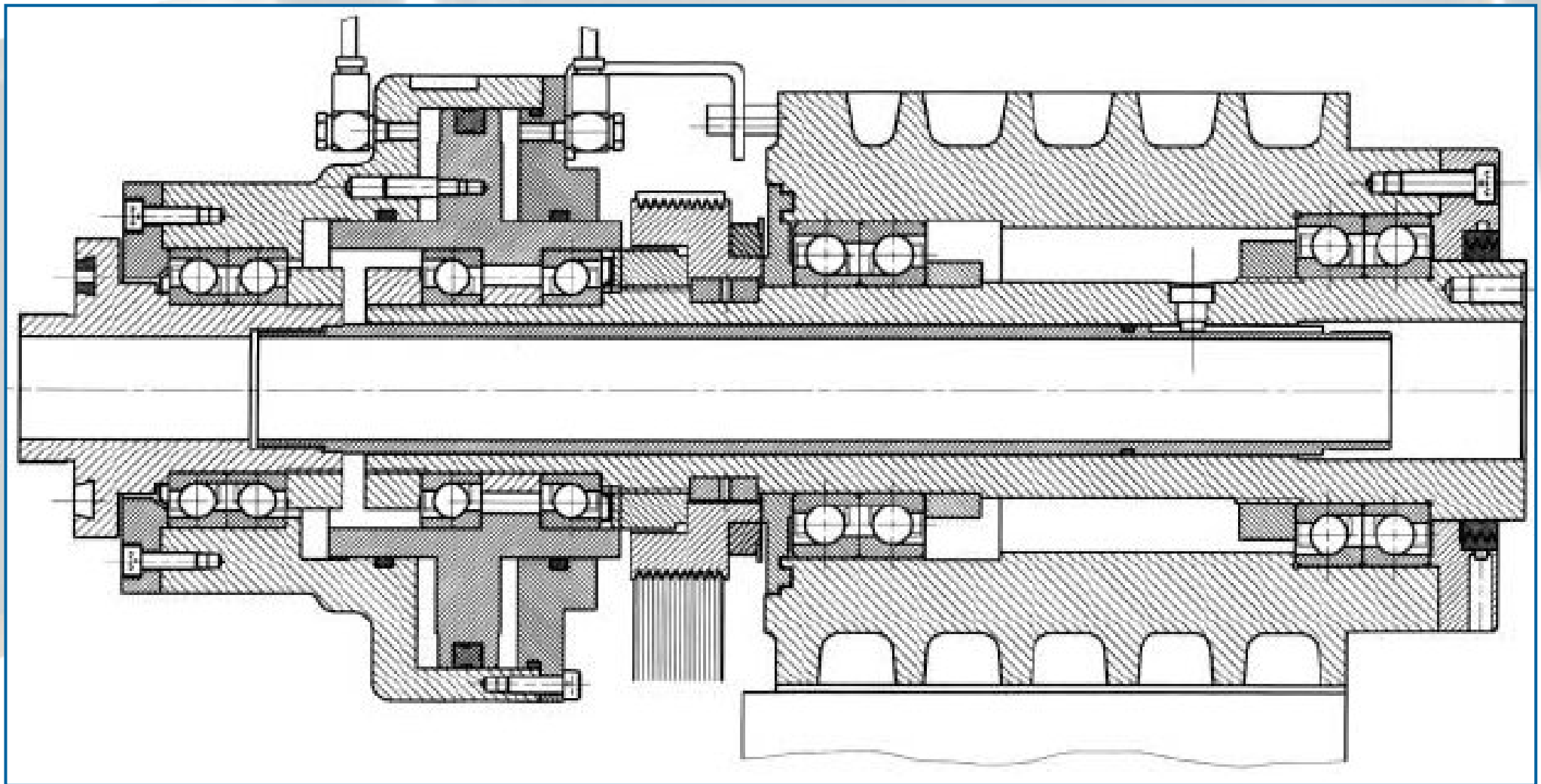

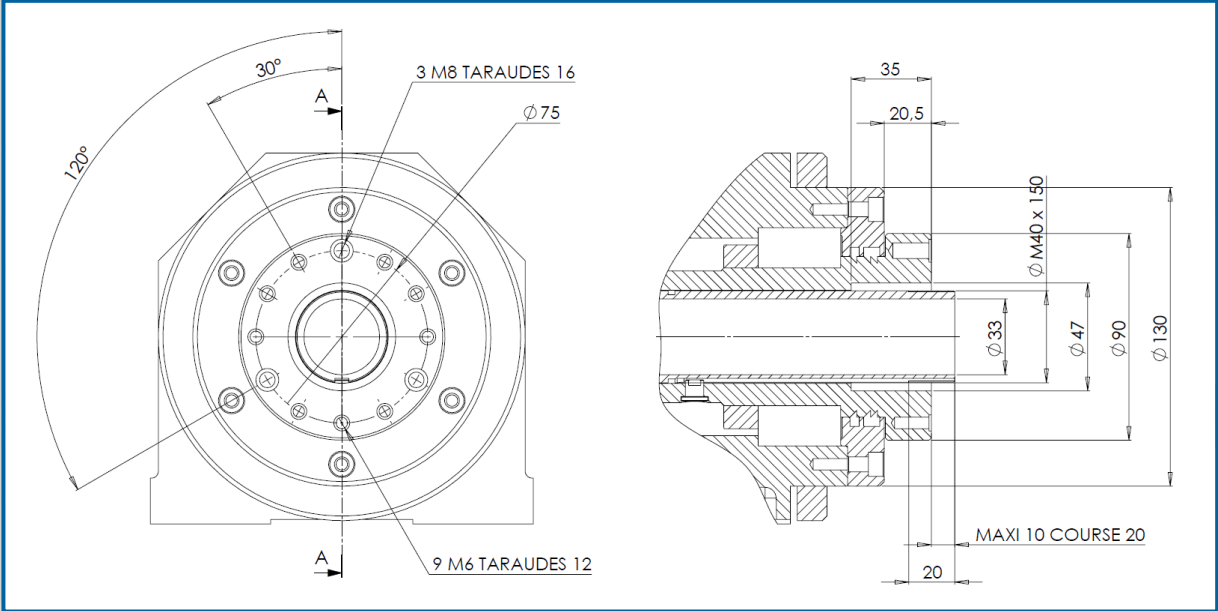

CONTROLE CIRCULATITE

MESURE 1

☉ 0.37 µm
 E: 3.07 µm
 phi: 289.1
 Filt: 15
 LSC

90

0.5 µm

180

270

Fournis./Client:	REALMECA	PlanContr:	CYLINDRE
Désign.Pièce:	BROCHE RT3	Pièce Nr.:	R5/30/05
Dessin Nr.:	212 T 030310	HOMMEL TESTER FORM 1000	
Commande Nr.:	OF:110758		
Remarque:	CONTROLE FINAL		
Contrôleur:	LE NORMAND.J	Date:	19.09.06
		Heure:	13.06.34

X-axis

Z-axis

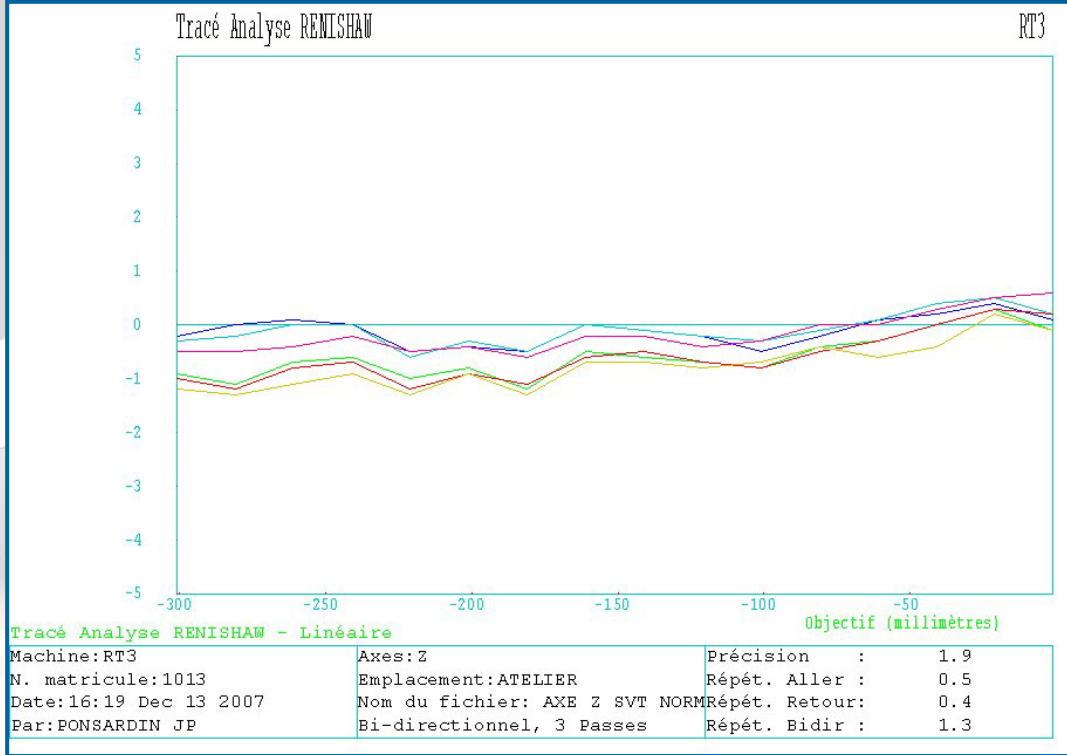
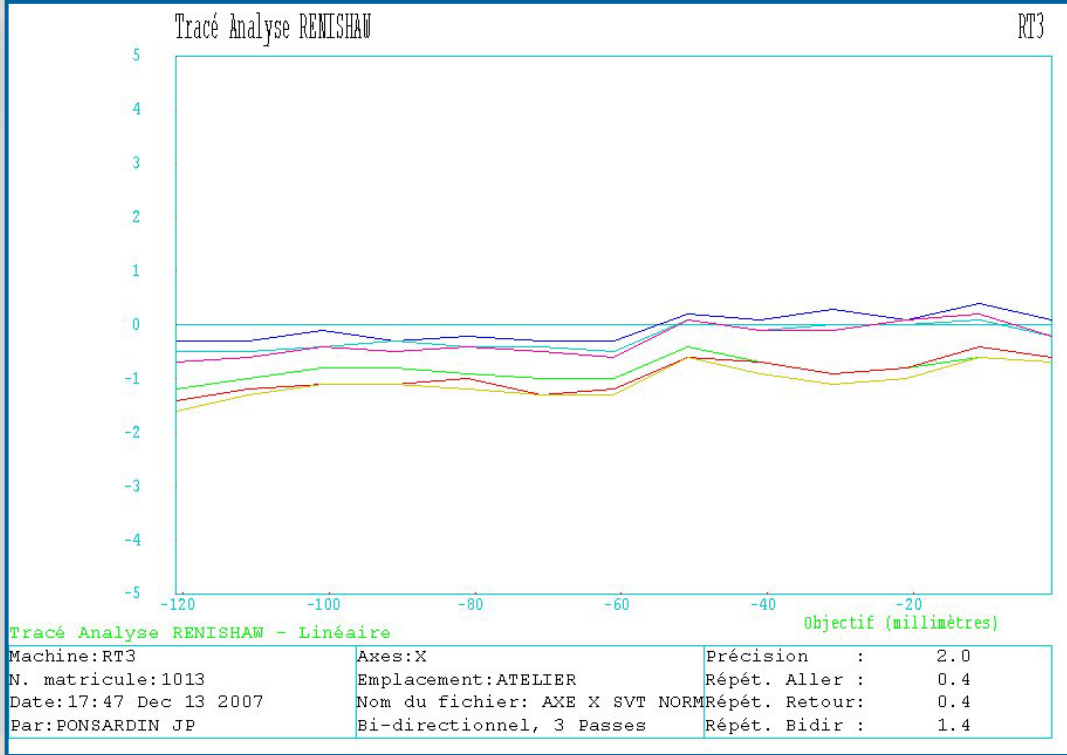

Accuracy : 2.0
 Repetition forward : 0.4
 Repetition backward : 0.4
 Repetition bidirectional : 1.4

Accuracy : 1.9
 Repetition forward : 0.5
 Repetition backward : 0.4
 Repetition bidirectional : 1.3

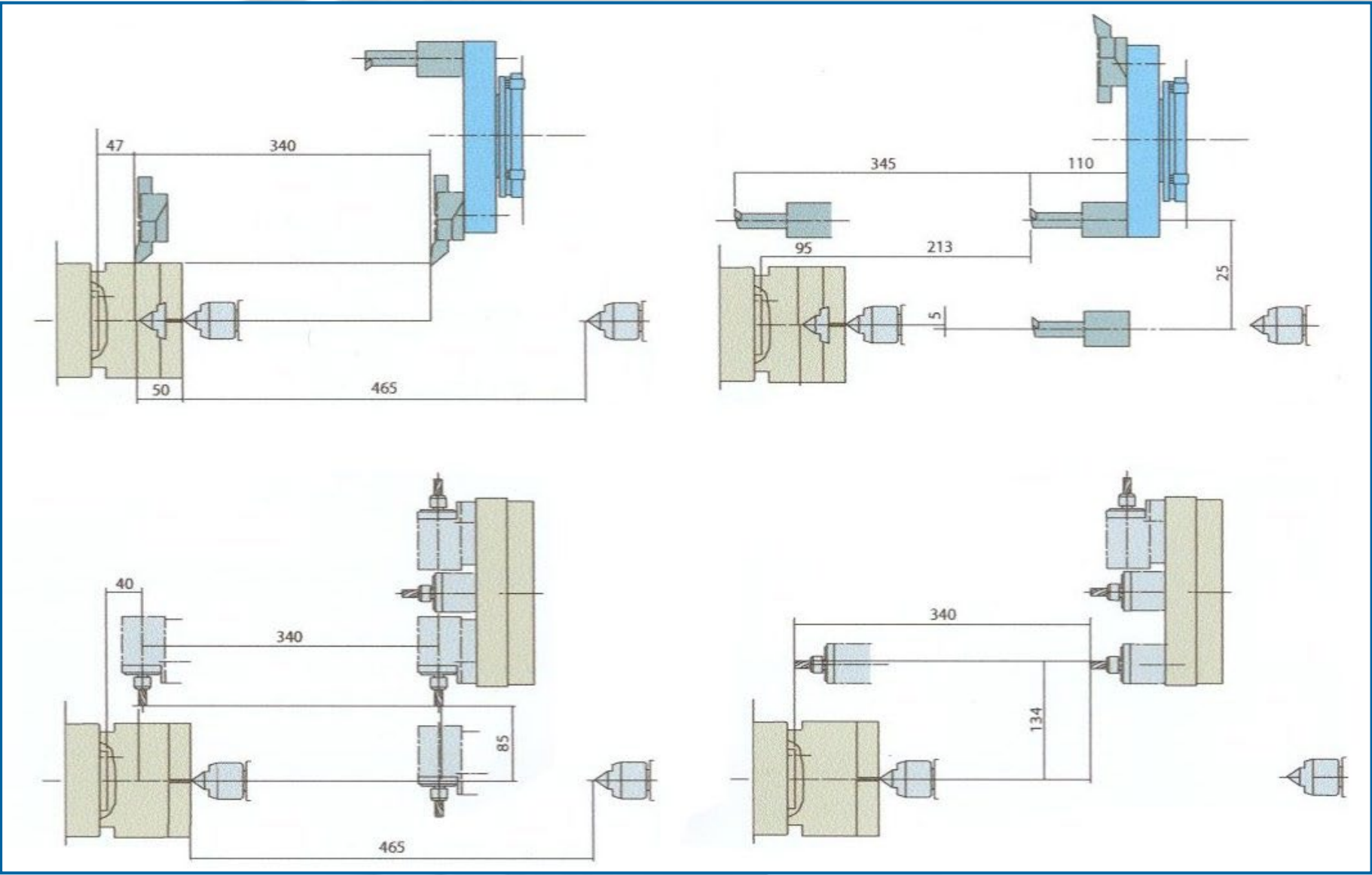

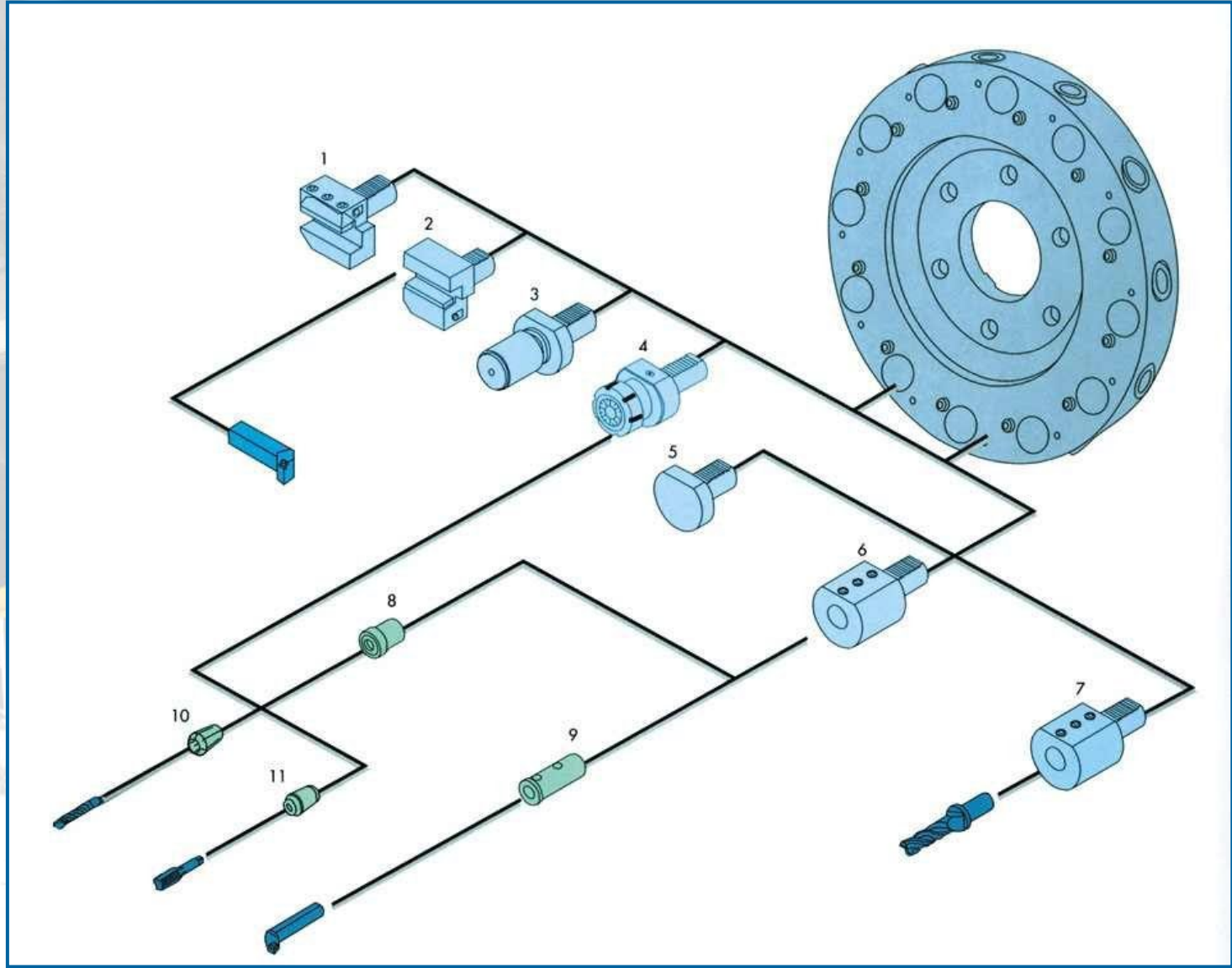

Draw-type gripper holder **5C** or
W20-25-31,75



2, 3 or 4 jaws
chuck, Ø130



Pressure-type gripper
holder **F27-28-32-38**



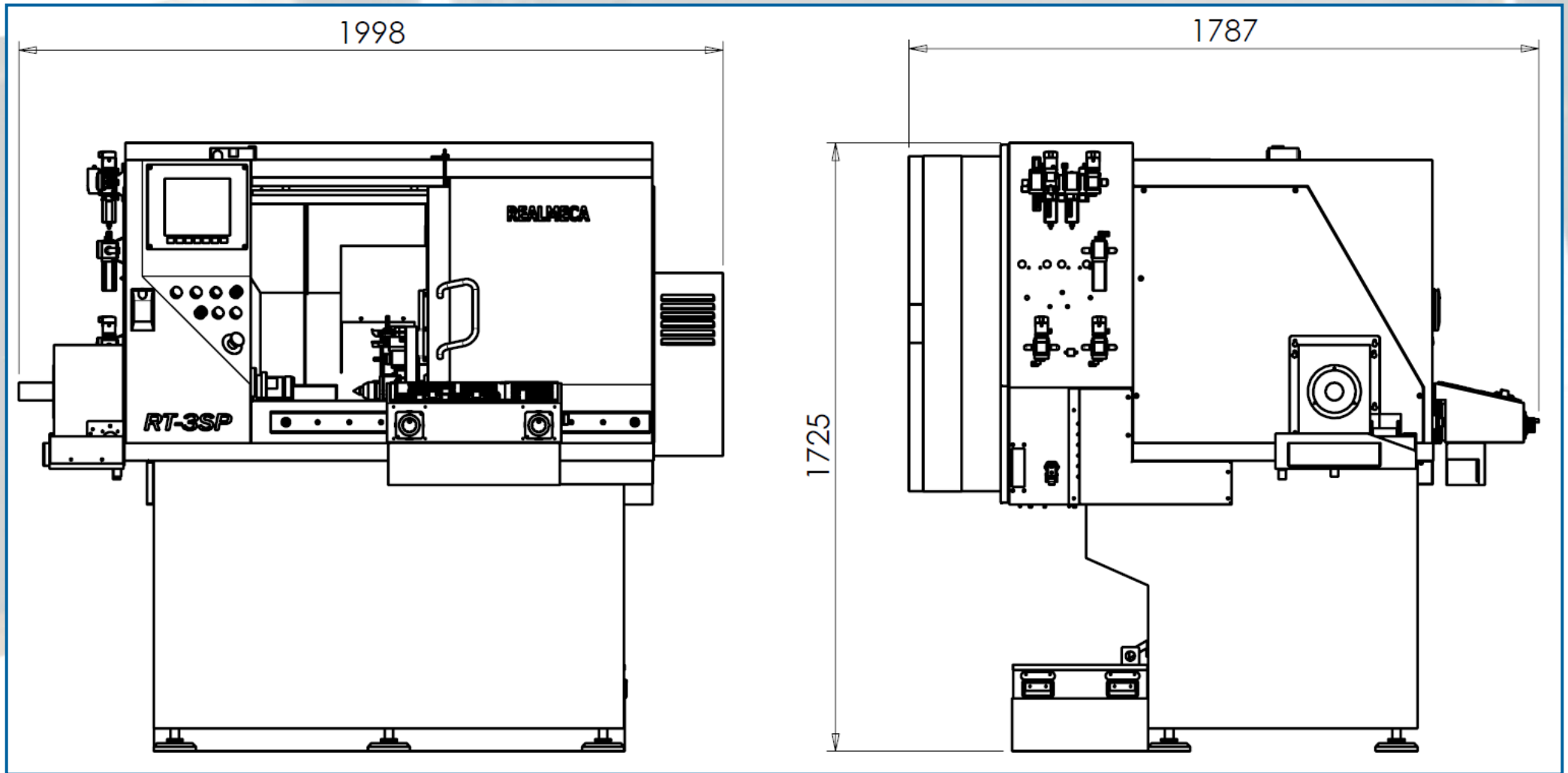

REALMECA

B.P.10 – 1 route d'Aubréville
55120 Clermont-en-Argonne – FRANCE

Tél. : +33 (0)3 29 87 41 75 – Fax : +33 (0)3 29 87 44 46

commercial@realmeca.com

www.realmeca.com

