

RT-5 SP



HIGH PRECISION LATHE

REALMECA

BUILT like a ROCK

A medium capacity and high precision lathe, designed for micromechanics :

- Made for low-to-medium production volumes ;
- Its bed is made of a composite material of high density guarantying :
 - Vibration absorption,
 - High stress resistance,
 - Thermal stability;
- High speed spindle ;
- Designed for easy chip evacuation ;
- High-precision, selectively sorted needle roller guides ;
- 2µm flatness, parallelism and perpendicularity ;
- Short drive chain ;
- Phosphate treatment of metal surfaces.

CAPACITY	
X axis	200 mm
Z axis	585 mm
Between centers	700 mm
Tailstock	CM4
C axis	360 000 x 0,001°
SPINDLE	
Max. speed	5000 rpm
Max. rating	9/12 kW
Spindle nose	Ø 110 mm
Bar capacity	42 mm
FEEDRATES	
Max. cutting	15m/min
Rapids	15m/min
C axis	300 rpm
Precision	0,1µ / 0,001°
TURRET	
Capacity VDI 30	12
SIZE / MASS	
Length / Width / Height	2600 x 1750 x 1700 mm
Weight	3100 kg

OPTIONS	
LIVE-TOOLING	
Capacity VDI 20	12
Number of live-tool position	6
Max. rpm	6000 rpm
SPINDLE	
Max. speed	5000 rpm
Max. rating	15/21 kW

12 tools VDI30 turret



Pneumatic tailstock

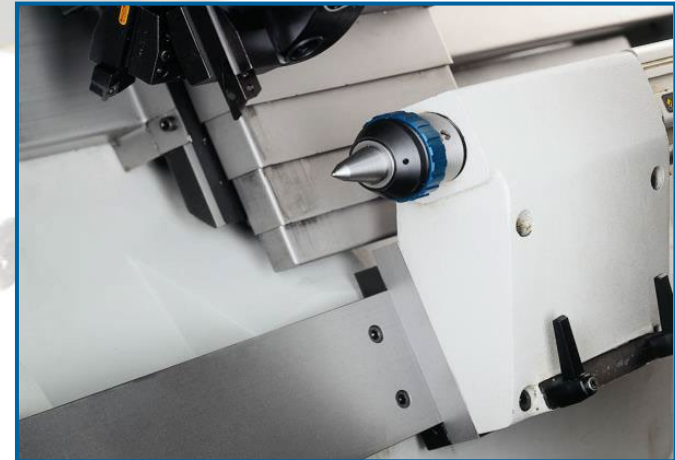

- **Spindle motor 15/21 kW**
- **Pneumatic or hydraulic clamping**
- **Chip conveyor**
- **C-axis and 12 tools VDI20 turret with 6 live-tool position, 6 000rpm and 3kW**

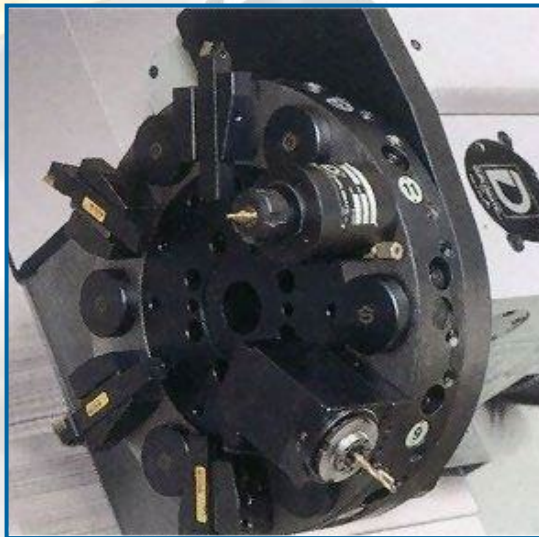

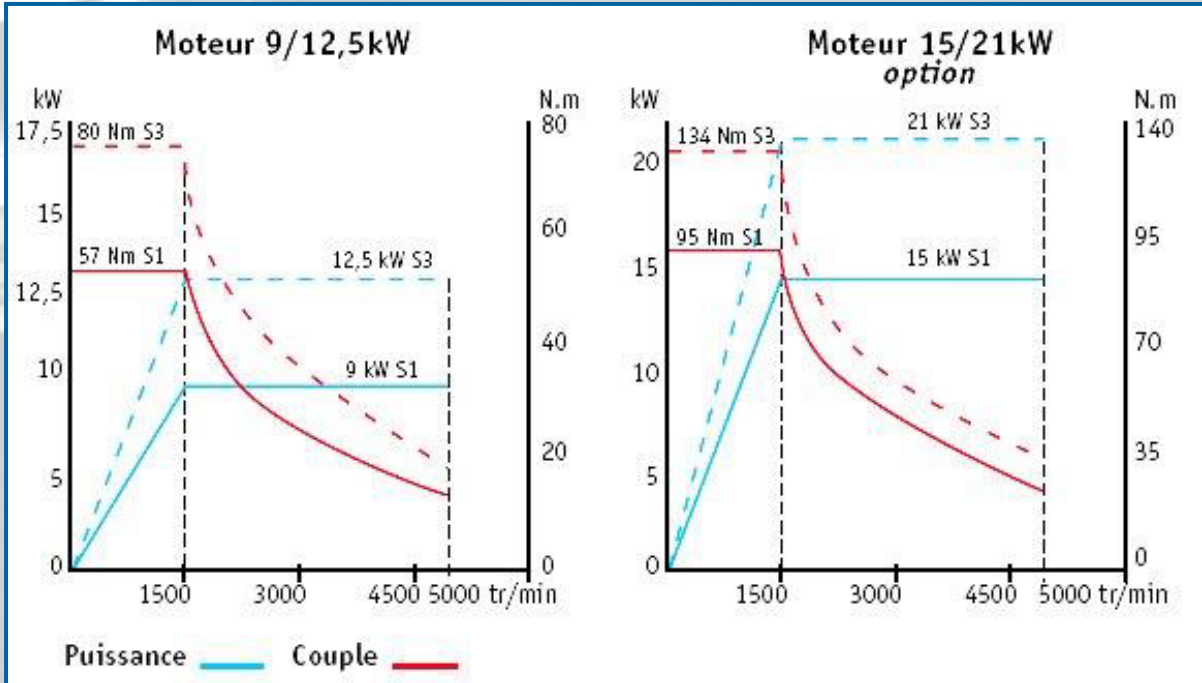

Power Torque

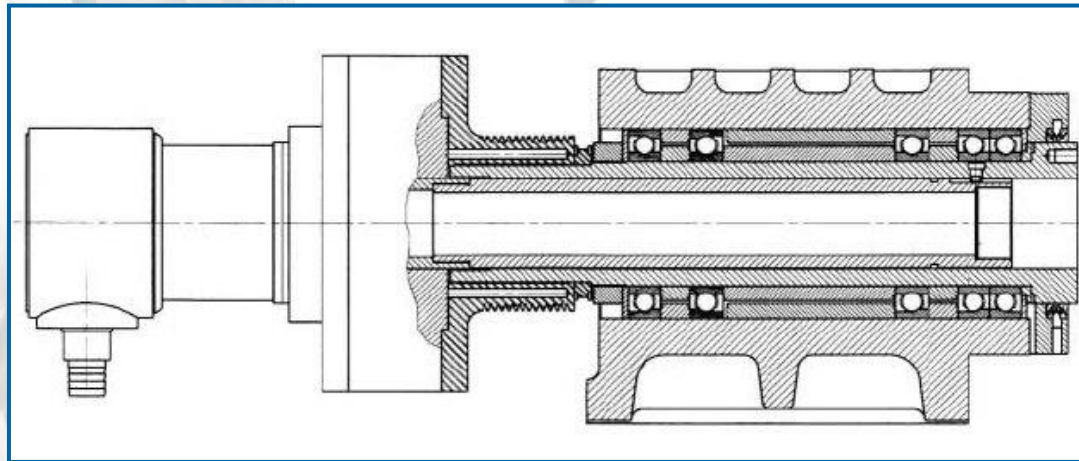
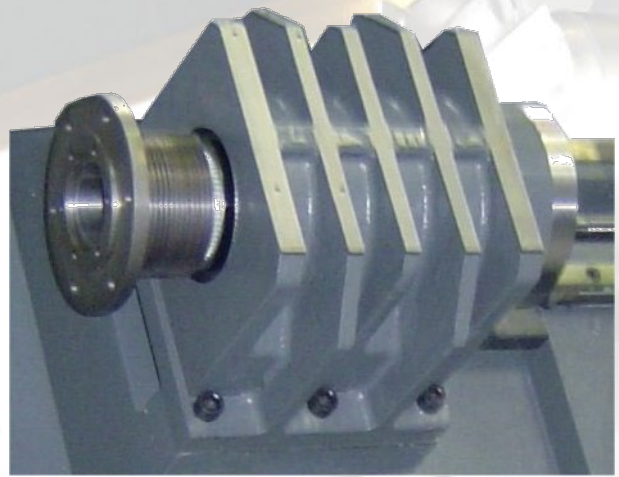

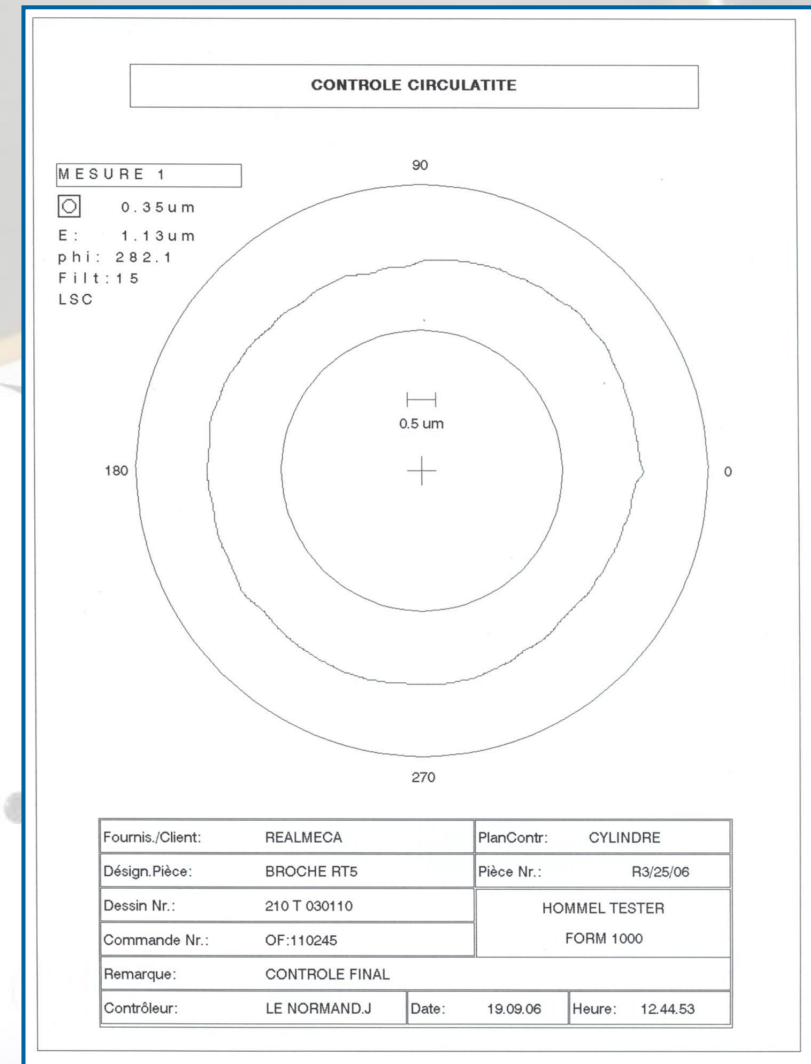
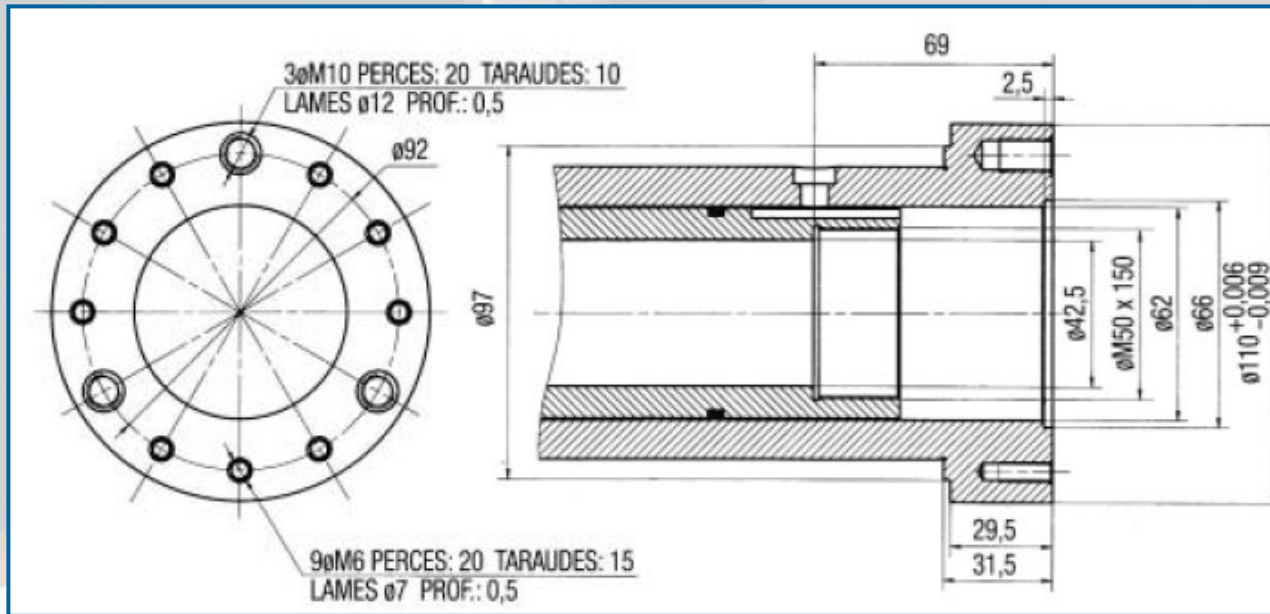

X-axis

Z-axis

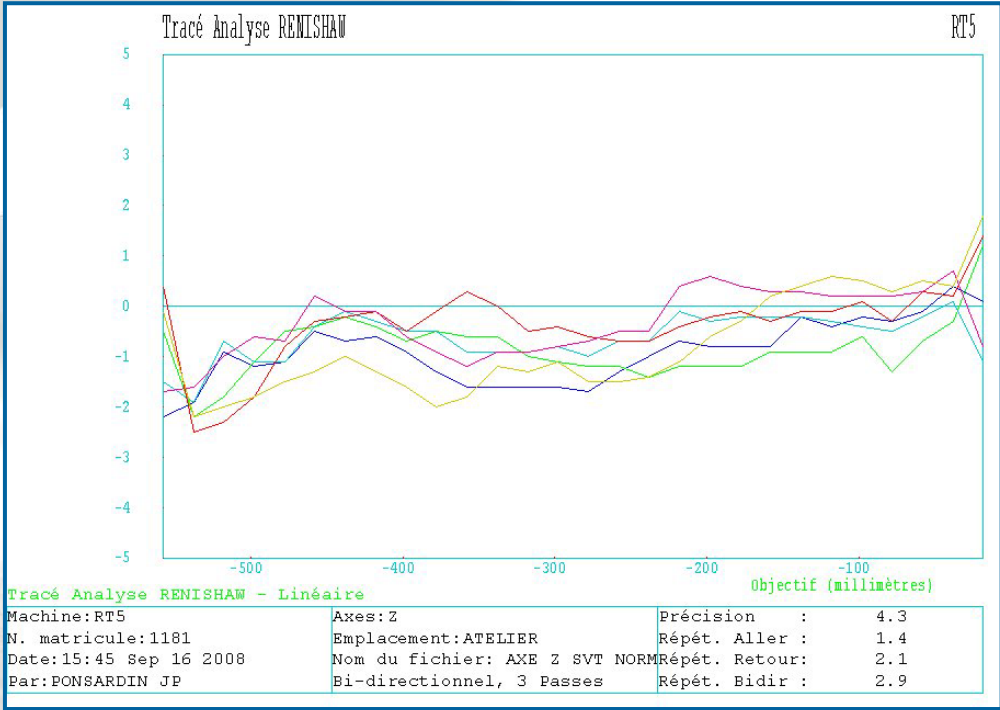
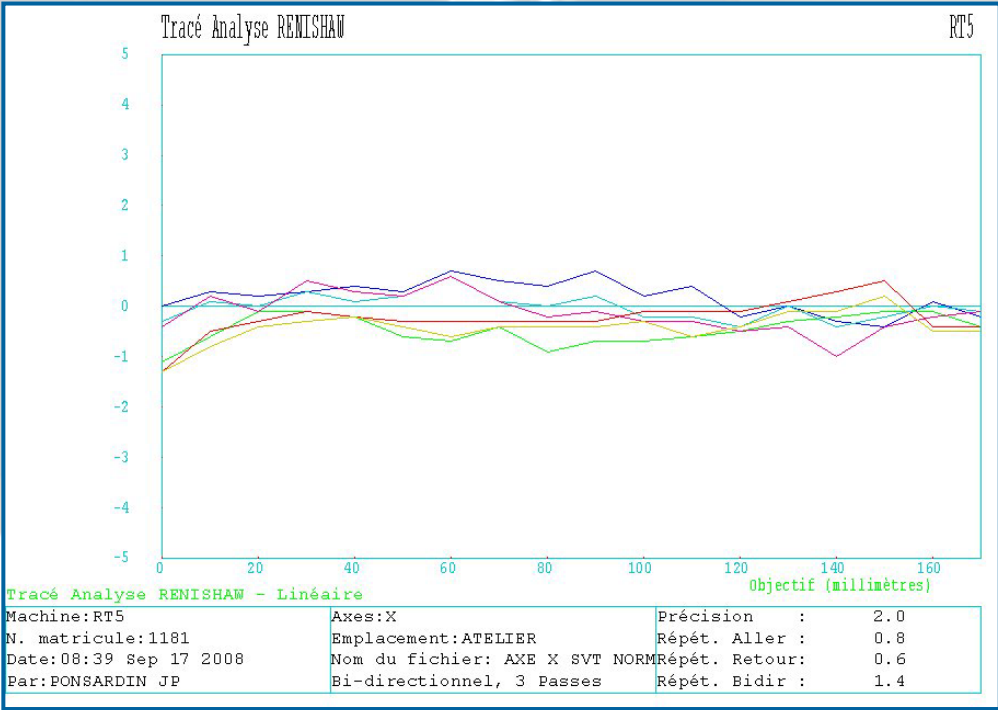

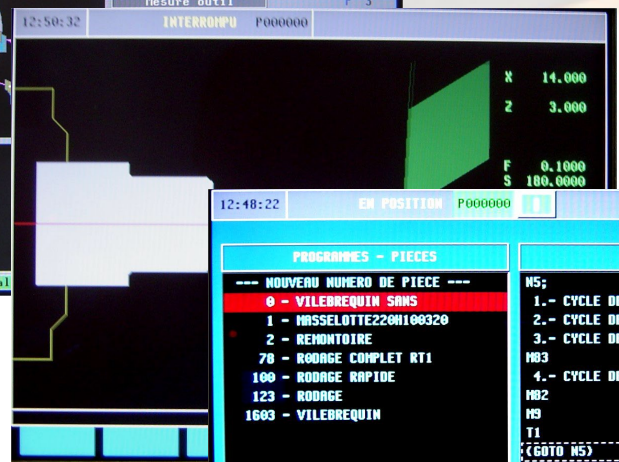

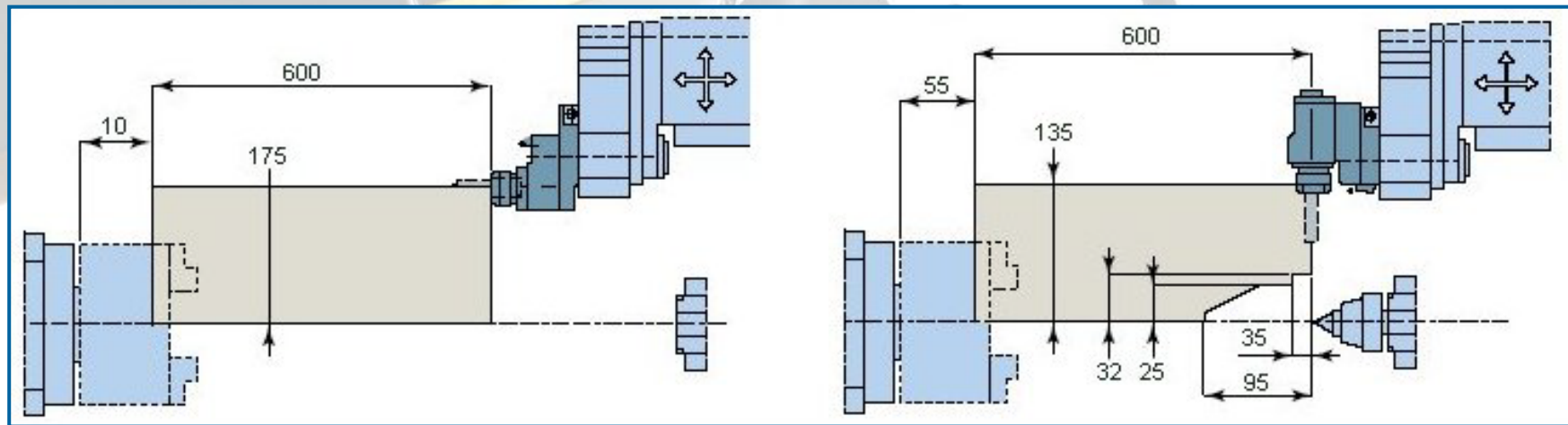
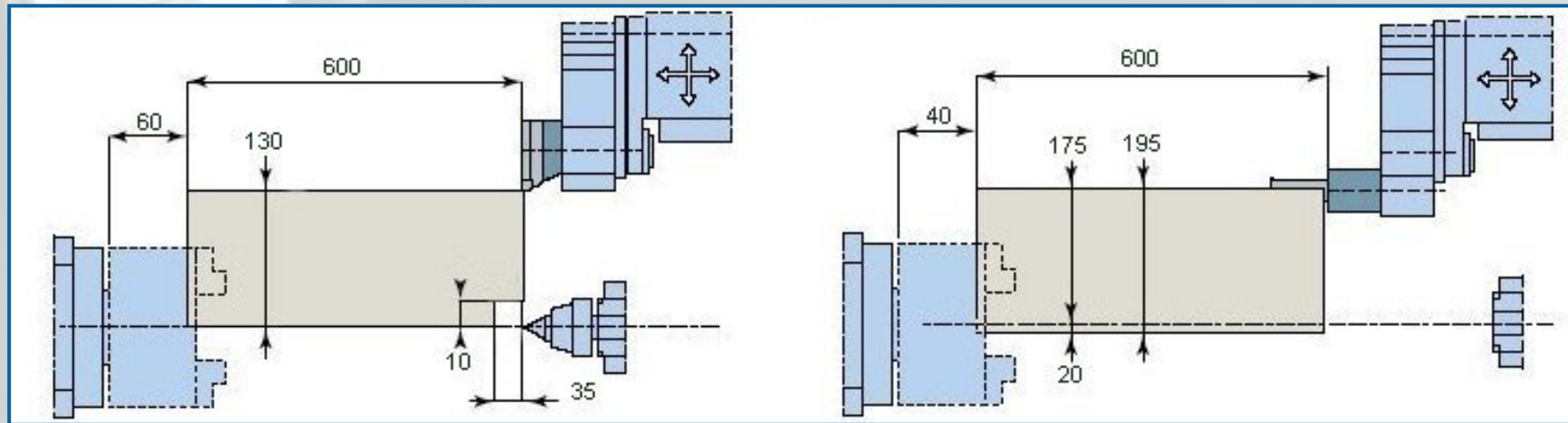

Draw-type gripper holder - type C or W



2, 3 or 4 jaws chuck



Pressure-type gripper holder - type F



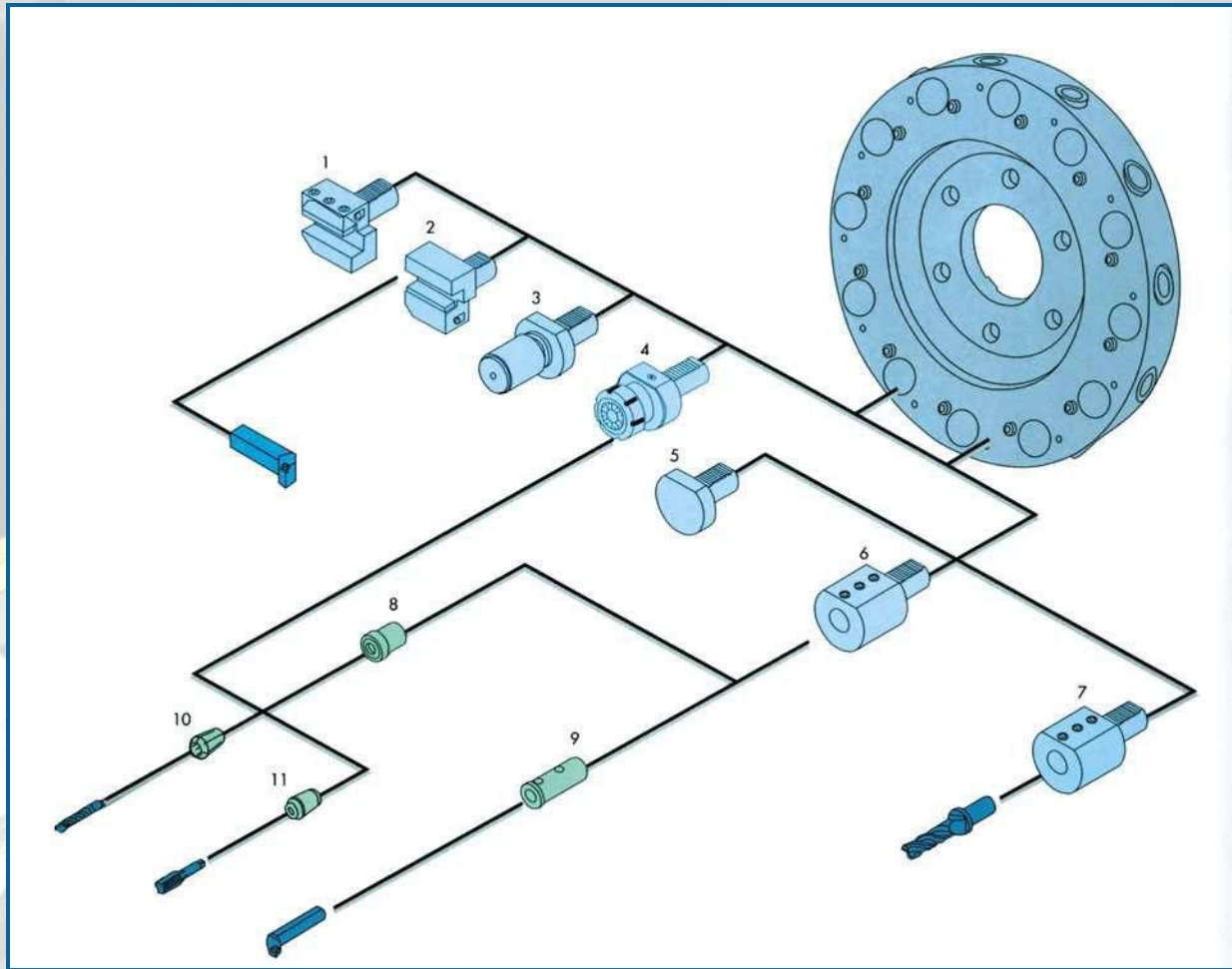
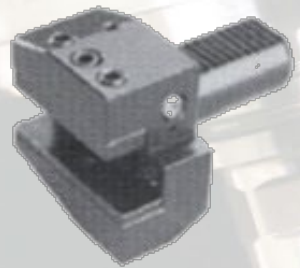
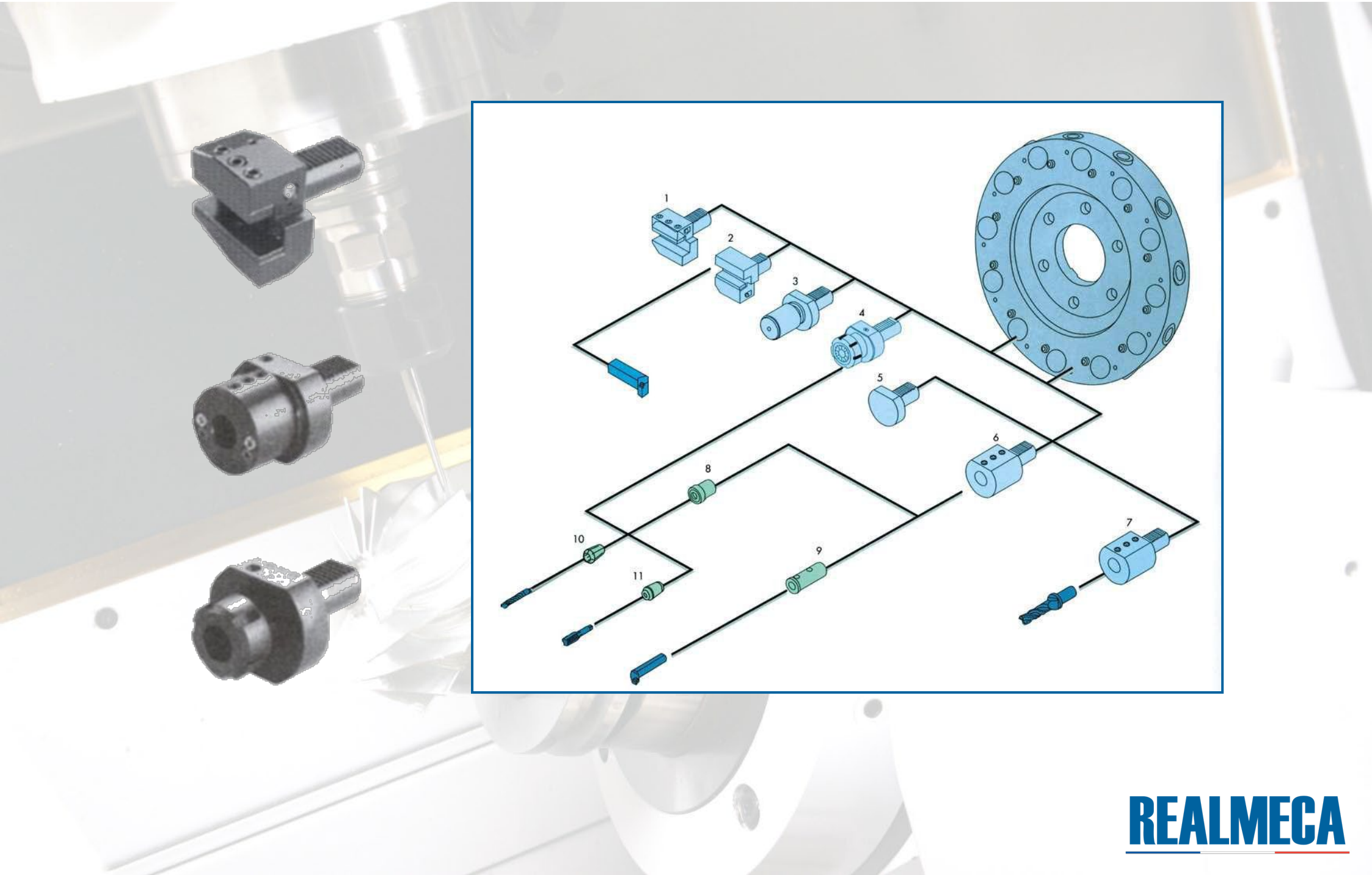

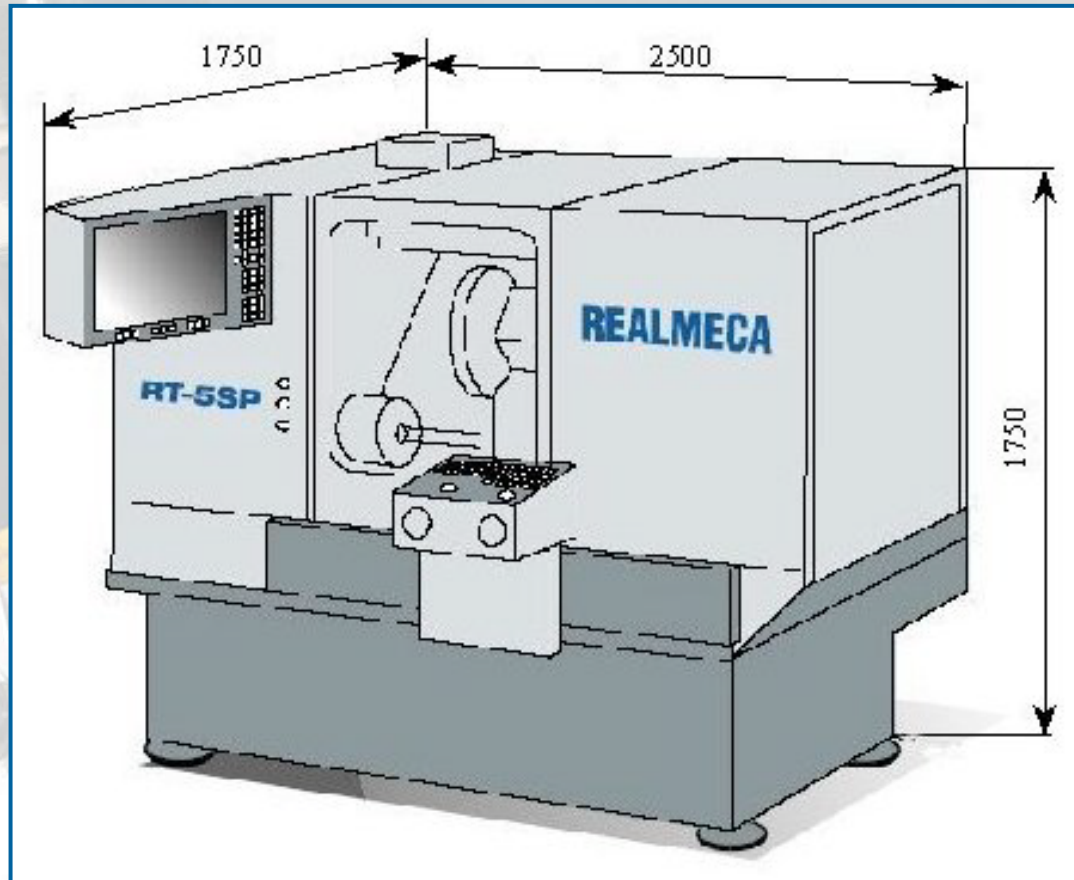

REALMECA

B.P.10 – 1 route d'Aubréville
55120 Clermont-en-Argonne – FRANCE

Tél. : +33 (0)3 29 87 41 75 – Fax : +33 (0)3 29 87 44 46

commercial@realmeca.com

www.realmeca.com

